

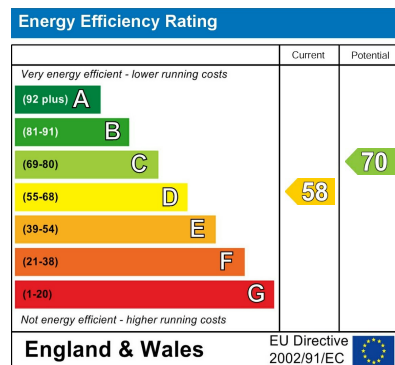

EST 1973
Paul Meakin Guide Price £300,000 Wentworth Way, South Croydon, CR2 9ET
 ESTATE AGENTS

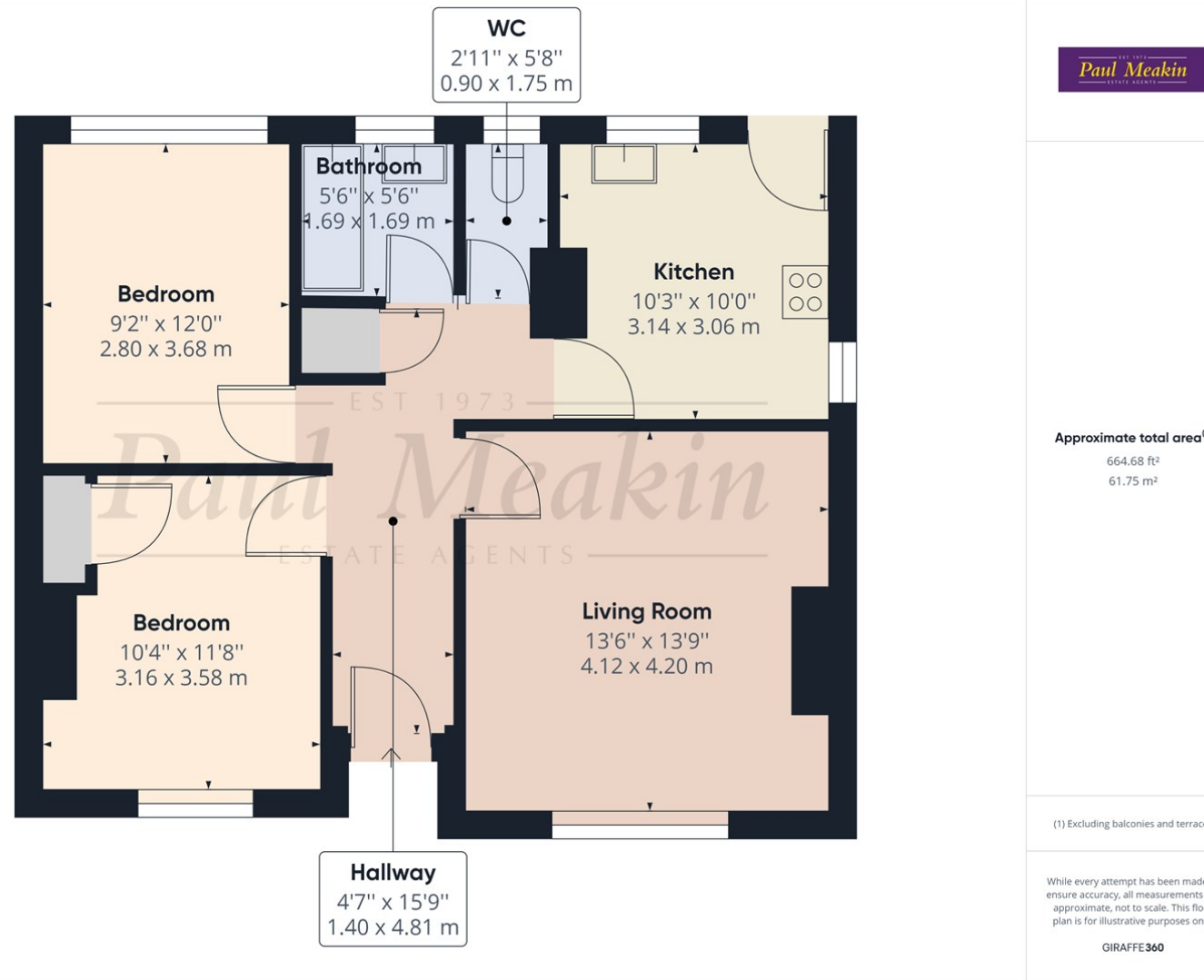

DRIVEWAY

ENTRANCE HALL
 4'7" x 15'9" (1.4 x 4.8)

LIVING ROOM
 13'6" x 13'9" (4.11 x 4.19)

KITCHEN
 10'3" x 10'0" (3.12 x 3.05)

BEDROOM
 10'4" x 11'8" (3.15 x 3.56)

BEDROOM
 9'2" x 12'0" (2.79 x 3.66)

BATHROOM
 5'6" x 5'6" (1.68 x 1.68)

SEPARATE WC
 2'11" x 5'8" (0.89 x 1.73)

PRIVATE REAR GARDEN

BRICK BUILT SHED

Paul Meakin are delighted to present to market this two double bedroom chain free ground floor maisonette with off road parking and private rear garden. Situated in a great residential road convenient for local transport links, amenities and selection of schools.

The property briefly comprises of large living room, refitted modern kitchen, two double bedrooms and family bathroom with separate WC. There is driveway to the front and the rear offers a good size garden mainly laid to lawn with a brick built shed.

An ideal purchase for a mix of buyers including first time and investors. Your earliest viewing is encouraged to appreciate size, location and presentation.

Wentworth way is well located in Hamsey Green/Sanderstead with excellent transport links and amenities. There is also local access to mainline railway stations including Upper Warlingham and Whyteleafe stations, providing frequent connections into Central London. Atwood Primary, Warlingham School and Warlingham sixth form are all located a short walk away.

Croydon council tax band C

Agents Note: Whilst every care has been taken to prepare these sales particulars, they are for guidance purposes only. All measurements are approximate are for general guidance purposes only and whilst every care has been taken to ensure their accuracy, they should not be relied upon and potential buyers are advised to recheck the measurements



- Two Double Bedrooms
- Private Rear Garden
- No Chain
- Leasehold
- Ground Floor Maisonette
- Driveway
- Popular Location
- Another Property Entrusted To Paul Meakin

